

# <>XPND

DIY PEDAL POWER CABLE

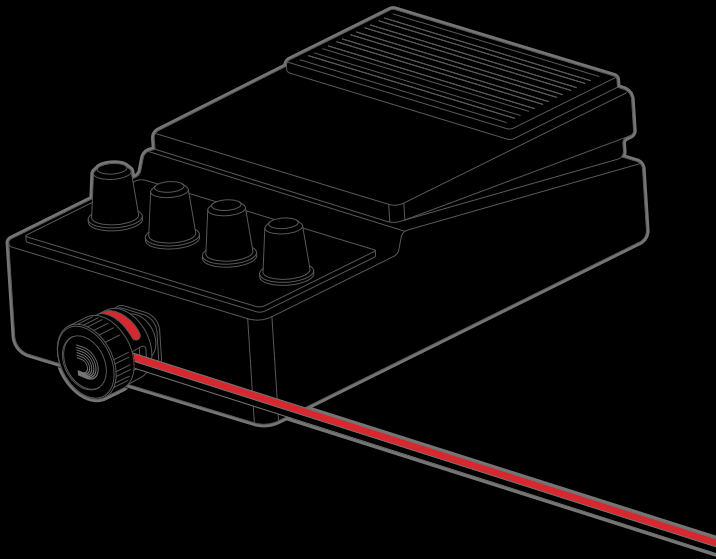



**\*Please Note** – Polarity is very important, please read and follow instructions carefully!

Match the color code on the wire and plug body to make proper polarity connections with the standard 5.5mm jack polarity used on the effects pedals.

For effects pedals the center pin (tip) is negative (ground) and the outer barrel (sleeve) is positive (hot). There are rare instances where a pedal has reversed polarity, but it is very uncommon.

Also be careful not to plug just any power supply with a 5.5 mm barrel jack into your pedal board.

Connecting a tip positive power supply to your system could cause permanent damage to your effects pedals.

Do not exceed milliamp draw of power supply output.

## INCLUDED PARTS



12 MALE  
PLUGS



2 FEMALE  
PLUGS

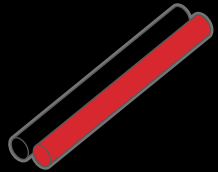

10 FT. (3M)  
CABLE

## CONSIDERATIONS

- You can move a plug anywhere you want, at any time to optimize its configuration for your specific needs. The wire insulation will close up and 'heal,' so you can clean up your wiring scheme as-needed.
- For proper placement, you may find it convenient to insert the plug bodies into each pedal power jack and run your wire to them while they remain inserted in your pedals.



**PLEASE NOTE** – Polarity is very important, read and follow instructions carefully!

1

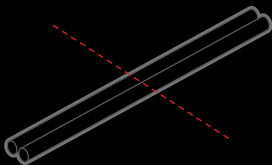

Measure and cut cable to length. Smooth out cable jacket end to cover any exposed conductor.

2



Apply plug to the cable. Screw the cap down clockwise until fully tightened and flush with plug body. **Be careful to line up the red wire with the red indicator on the plug.**

3

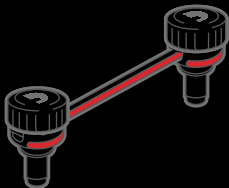

Apply plug to the other end of the cable to complete the connection.

4

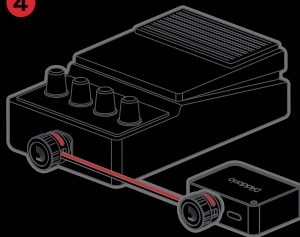

Connect cable to power source and pedal.

## OPTIONAL DAISY CHAIN

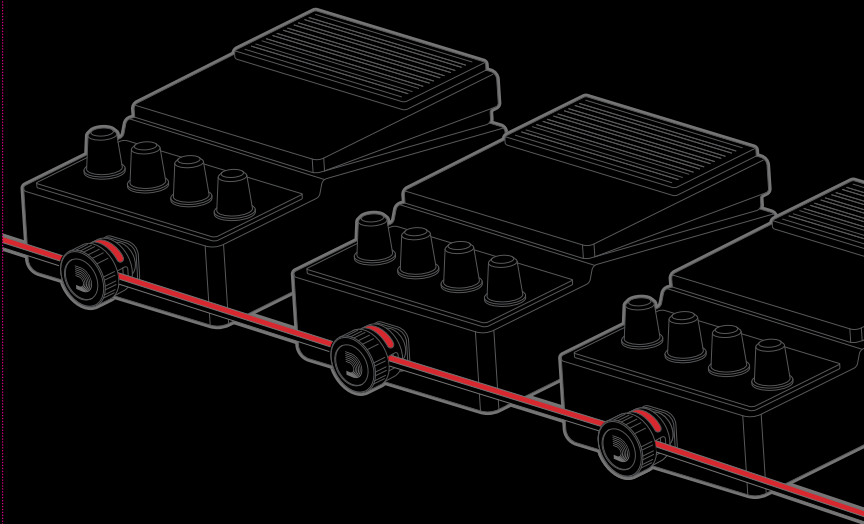

You can also daisy chain connections for powering multiple pedals from a single power source.

# PASS-THROUGH CONFIGURATION

## FOR TOP MOUNTED JACKS

1

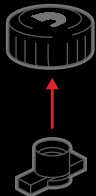

Assemble the pass-through insert by pushing insert into the cap of the plug.

2

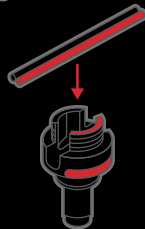

Insert the cable into the plug body. Be careful to line up the red wire with the red side of the plug.

3

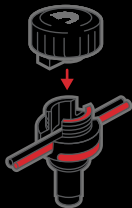

Screw the cap down clockwise until fully tightened and flush with the plug body.

4



Ensure the red wire is aligned with the red indicators on the plug body and that the cap has not been cross-threaded.

# FOLD-OVER CONFIGURATION

## FOR SIDE MOUNTED JACKS

1

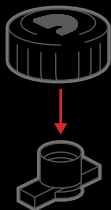

Remove the pass-through insert from the plug cap.

2

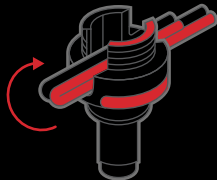

Pass the wire through the body of the plug. Fold the wire over on top of itself, keeping the red wire aligned.

3

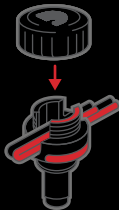

Screw the cap down clockwise until it is fully tightened and flush with the plug body.

4



Continue running wire to the next pedal or isolator, or snip remaining wire to neatly end the daisy chain.